

free pattern

Dragonfly Pond











- DESIGNED BY BENARTEX
- FINISHED SIZE: 62" X 70"

DRAGONFLY
Dance
By Kanvas Studio
ENHANCED WITH METALLIC GOLD

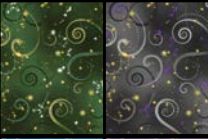
KANVAS
STUDIO

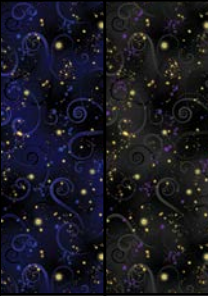
CUTTING INSTRUCTIONS

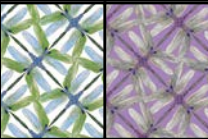
*WOF = Width of fabric | HST=Half Square Triangle | QST=Quarter Square Triangle
Sew strips via short ends, then subcut as indicated | Blue color-way | Purple color-way

	A	DANCING DRAGONFLIES 8498M-59 <i>Navy</i> 8498M-66 <i>Black</i>	1 FQ	(4) 4-1/2" squares (1) 12-1/2" square
	B	WATERLILY POOL 8499-51 <i>Lt Blue</i> 8499-11 <i>Gray/Purple</i>	1/3 yd	(2) 4-1/2" x WOF strips; subcut (2) 4-1/2" x 12-1/2" strips (2) 4-1/2" x 20-1/2" strips
	C	SWIRLING SKY 8500M-41 <i>Evergreen</i> 8500M-11 <i>Charcoal Gray</i>	1 FQ	(6) 5-1/4" squares, cut twice on the diagonal to yield (24) QST
	D	SWIRLING SKY 8500M-50 <i>Cobalt Blue</i> 8500M-60 <i>Med Purple</i>	2/3 yd	(1) 5-1/4" x WOF strip, subcut (6) 5-1/4" squares, cut twice on the diagonal to yield (24) QST (7) 2-1/4" x WOF strips*; Binding
	E	SWIRLING SKY 8500M-57 <i>Lt Blue</i> 8500M-13 <i>Dove Gray</i>	1-5/8 yd	(6) 4-1/2" x WOF strips; subcut (32) 4-1/2" squares (4) 4-1/2" x 20-1/2" strips (5) 5-1/4" x WOF strips; subcut (24) 5-1/4" squares, cut twice on the diagonal to yield (96) QST (10) 4-7/8" squares, cut once on the diagonal to yield (20) HST
	F	SWIRLING SKY 8500M-59 <i>Navy</i> 8500M-99 <i>Black</i>	3/4 yd	(3) 5-1/4" x WOF strips, subcut (12) 5-1/4" squares, cut twice on the diagonal to yield (48) QST (10) 4-7/8" squares, cut once on the diagonal to yield (20) HST (3) 2-1/2" x WOF strips; subcut (2) 2-1/2" x 20-1/2" strips (2) 2-1/2" x 24-1/2" strips
	G	GILDED WINGS 8501M-50 <i>Cobalt Blue</i> 8501M-61 <i>Lavendar Gray</i>	3/4 yd	(6) 3-1/2" x WOF strips*; Middle Border
	H	PINWHEEL GEO 8502M-40 <i>White/Green</i> 8502M-61 <i>Lavendar Gray</i>	1 FQ	(8) 4-1/2" squares
	I	DANCING WAVES 8503M-55 <i>Navy Blue</i> 8503M-11 <i>Black/Purple</i>	1 yd	(12) 2-1/2" x WOF strips*; Inner and Outer Borders

BLOCK 1 ASSEMBLY

1 Sew (1) F QST to (1) E QST. *Make 48.*

2 Sew (1) D QST to (1) E QST. *Make 24.*

3 Sew (1) C QST to (1) E QST. *Make 24.*



4 Sew (1) FE unit to (1) DE unit to make FED square. Square to 4-1/2". *Make 24.*

5 Sew (1) CE unit to (1) FE unit to make CEF square. Square to 4-1/2". *Make 24.*



6 Sew (1) E 4-1/2" square to each side of (1) FED square. *Make 4.*



7 Sew (1) E 4-1/2" square to each side of (1) DEF square. *Make 4.*

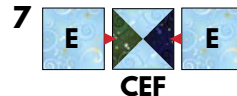

8 Sew (1) CEF unit and (1) FED unit to each side of (1) A 4-1/2" square. *Make 4.*



9 Sew rows together, as shown. Square to 12-1/2". *Make 4.*

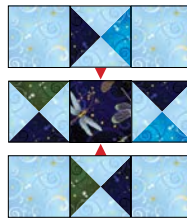

BLOCK 2 ASSEMBLY

10 Sew (1) E HST to (1) F HST. *Make 20.*



11 Sew (1) E 4-1/2" square and (1) EF square to each side of (1) CEF square, as shown. *Make 8.*

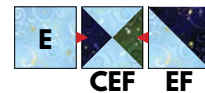

12 Sew (1) E 4-1/2" square and (1) EF square to each side of (1) FED square, as shown. *Make 8.*



13 Sew (1) CEF square and (1) FED square to each side of (1) H 4-1/2" square, as shown. *Make 8.*

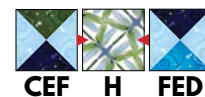

14 Sew rows together, as shown. Square to 12-1/2". *Make 8.*

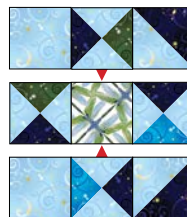

CENTER BLOCK ASSEMBLY

15 Sew (1) B 4-1/2" x 12-1/2" strip to each side of (1) A 12-1/2" square.

16 Sew (1) B 4-1/2" x 20-1/2" strip to top and bottom of sewn unit.

17 Sew (1) F 2-1/2" x 20-1/2" strip to each side of sewn unit.

18 Sew (1) F 2-1/2" x 24-1/2" strip to top and bottom of sewn unit. Square to 24-1/2".

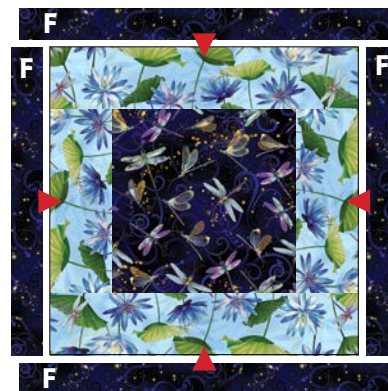
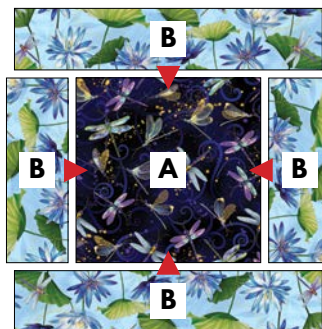

TOP/BOTTOM ROW ASSEMBLY

19 Sew (1) E 4-1/2" x 20-1/2" strip to (1) EF square. *Make 4.*



20 Sew (2) sewn units together to complete row. *Make 2.*



QUILT CENTER ASSEMBLY

21 Sew (2) Block 2's together, as shown in Quilt Diagram. *Make 4.*

22 Sew (1) Block 2 sewn unit to each side of Center Block.

23 Sew (1) Block 1 to each side of Block 2 sewn unit. *Make 2.*

24 Sew rows together, as shown in Quilt Diagram.

QUILT DIAGRAM (FINISHED SIZE: 62" X 70")

BORDER ASSEMBLY

Measure width and length of the quilt top to ensure border sizes, below are our cutting sizes.

25 INNER BORDER: Sew (1) I 2-1/2" x (56-1/2") strip to each side of quilt center.

26 INNER BORDER: Sew (1) I 2-1/2" x (52-1/2") strip to top and bottom of quilt center.

27 MIDDLE BORDER: Sew (1) G 3-1/2" x (60-1/2") strip to each side of quilt center.

28 MIDDLE BORDER: Sew (1) G 3-1/2" x (58-1/2") strip to top and bottom of quilt center.

29 OUTER BORDER: Sew (1) I 2-1/2" x (66-1/2") strip to each side of quilt center.

30 OUTER BORDER: Sew (1) I 2-1/2" x (62-1/2") strip to top and bottom of quilt center.

FINISHING: Cut batting and backing 3" larger than top on all sides. Layer backing, batting and top together and baste or pin. When quilting is completed, trim excess batting and backing. Bind as usual.



NOTE: If this Benartex pattern is included in a kit, any questions about the kit should be addressed to the vendor from whom you bought it.

Share your finished quilt with the Benartex community on social media by tagging #benartexfabrics!